

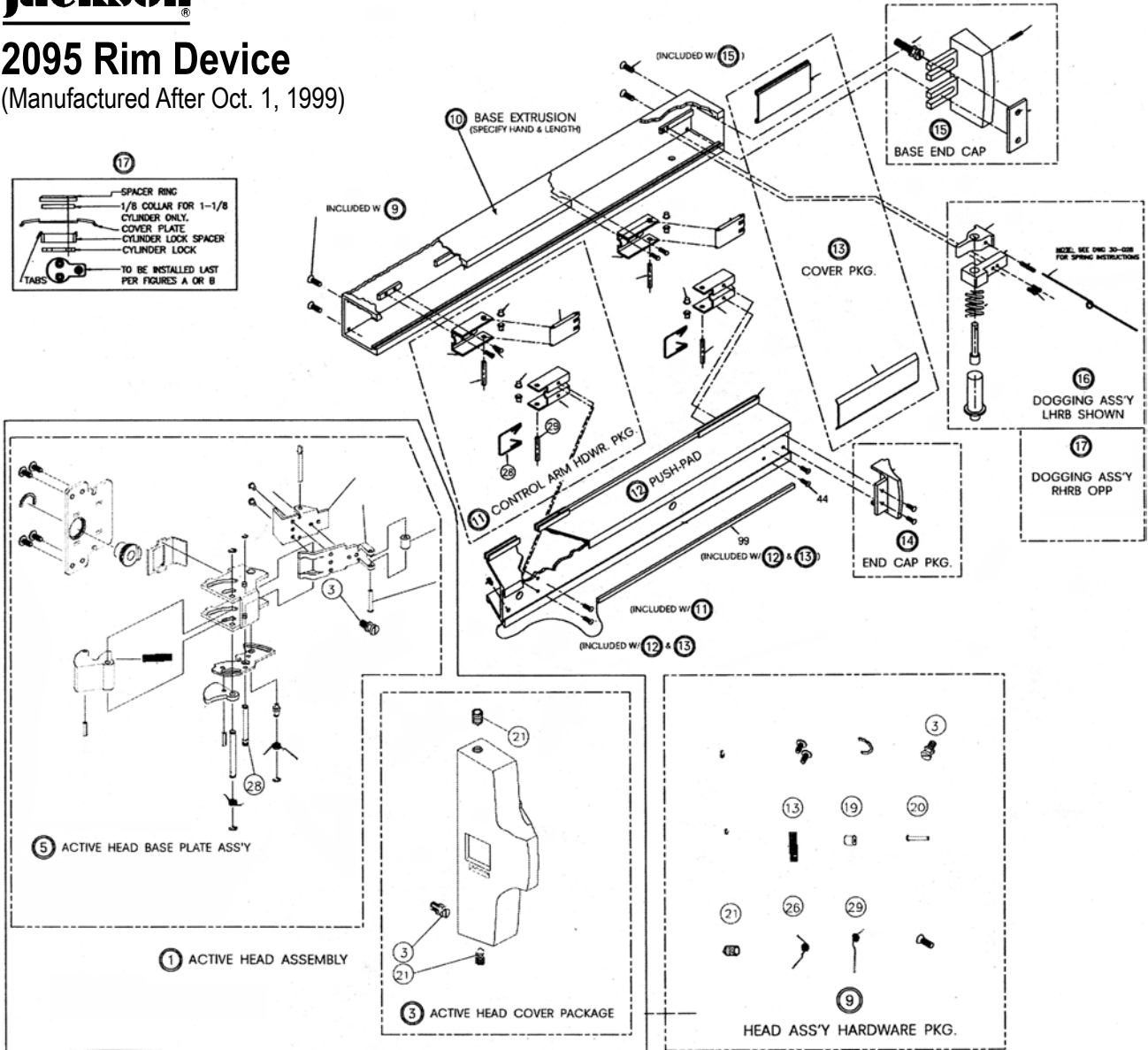

2095 Rim Device

(Manufactured After Oct. 1, 1999)



#	Part #	Description	Finish
1	30-2622	Complete Active Head Assy	F
3	30-2627	Active Head Cover Package	F
5	30-2635	Active Head Base Plate Assembly	
9	30-2610	Head Assembly Hardware Package	
11	30-1064	Control Arm Hardware Package	
12	30-1048-PKG	Push-Pad Package	F
13	30-1263	Cover Plate Package	F
14	30-1265	Push-Pad End Cap Package	F
15	30-1266	Base End Cap Package	F
16	30-2467	Dogging Assembly (LHRB) Shown	
17	30-2462	Dogging Assembly (RHRB) Opp.	



• Main Largo Florida Warehouse: 800-282-2837, Fax: 800-447-2299
 • Atlanta: 877-217-9396 • Charlotte: 888-571-9145 • South Florida: 888-780-6071
www.southernlock.com E-mail: sales@southernlock.com